

申请可作为学校用途的楼宇安全证明书时 必须提供的资料

向消防处及屋宇署/房屋局常任秘书长办公室独立审查组递交已填妥的申请书之前，申请人必须检视下列事项是否已经办妥 –

1. 有否将申请书上要求提供的所需资料全部填妥。
2. 有否随每份申请书夹附足够数目的图则。
3. 图则上是否有下列资料：
 - a. 勾划拟用作校舍的注册范围；
 - b. 注明校名、校址、申请日期、申请人的姓名及签署；
 - c. 指出各课室、走廊、门口、走火通道、防火门、出口路线/出口门及房产内其他部份的用途(例如：洗手间、办公室等)的位置及其尺寸(以毫米为单位，而比例通常须为 1:50 或 1:100)；
 - d. 列明各房间的用途及课室编号；
 - e. 显示每个课室最高可容纳的人数(老师和学生的数目)及将要容纳的学校教职员总数；
 - f. 列明任何拟用作间隔墙和出口门的建造物料(如有)；
 - g. 指示任何改建的工程(如有)；
 - h. 校舍内提供儿童睡觉的地方(如有)；及
 - i. 校舍内现有消防装置及设备的描述。

SAMPLE

SCHOOL NAME:
 SCHOOL ADDRESS:
 CORRESPONDENCE ADDRESS:
 CONTACT PERSON & NUMBER:

APPLICANT NAME:
 APPLICANT'S SIGNATURE:
 APPLICATION DATE:
 DRAWING NUMBER:

PROPOSED SCHOOL LAYOUT PLAN (SCALE 1 : 100 @ A3 PAPER)

PEDESTRIAN CONCOURSE

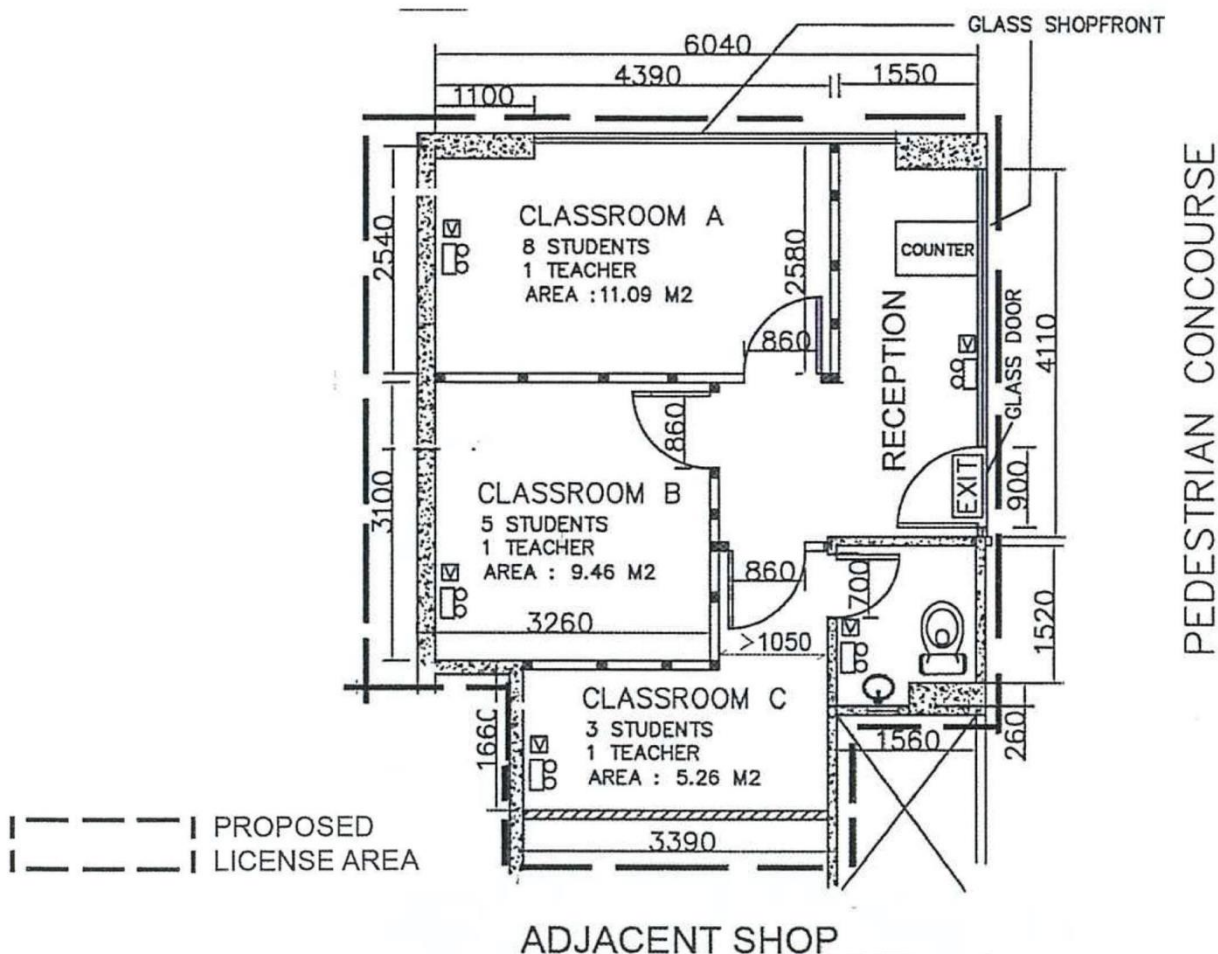

REMARKS :

- PROPOSED
- LICENSE AREA
- EXISTING WALL PARTITION / COLUMN AS PER APPROVED BUILDING PLAN
- EXISTING SOLID CONCRETE BLOCK WALL
- NEW LIGHT WEIGHT GYPSUM BOARD WALL PARTITION (ABOUT 80MM TH)
- TIMBER HOLLOW CORE DOOR OF WIDTH 860MM WITH VISION PANEL UNLESS OTHERWISE STATED
- NEW EMERGENCY LIGHTS INSTALLED AT H/L WITH RECHARGABLE BATTERY
- NEW CEILING-TYPE VISUAL FIRE ALARM
- NEW EXIT SIGN AT H/L WITH RECHARGABLE BATTERY

	NO. OF STUDENTS	NO. OF TEACHERS	
CLASSROOM A (11.09 M2)	8 NOS.	1 NO.	PROPOSED STUDENT NOS. = 16 PROPOSED TEACHER NOS. = 3 TOTAL POPULATION = 19 PEOPLE NO EXTRA POPULATION SHALL BE GENERATED AT RECEPTION
CLASSROOM B (9.46 M2)	5 NOS.	1 NO.	
CLASSROOM C (5.26 M2)	3 NOS.	1 NO.	